



WF 9221 series

**SINGLE / DOUBLE NEEDLE, EXTRA HEAVY DUTY, WALKING
FOOT MACHINE WITH LARGE WORKING SPACE (76 cm)**

**INSTRUCTION / OPERATING MANUAL
PARTS MANUAL**

WEBSITE :

E-MAIL :

WWW.IMCA.NET

INFO@IMCA.NET

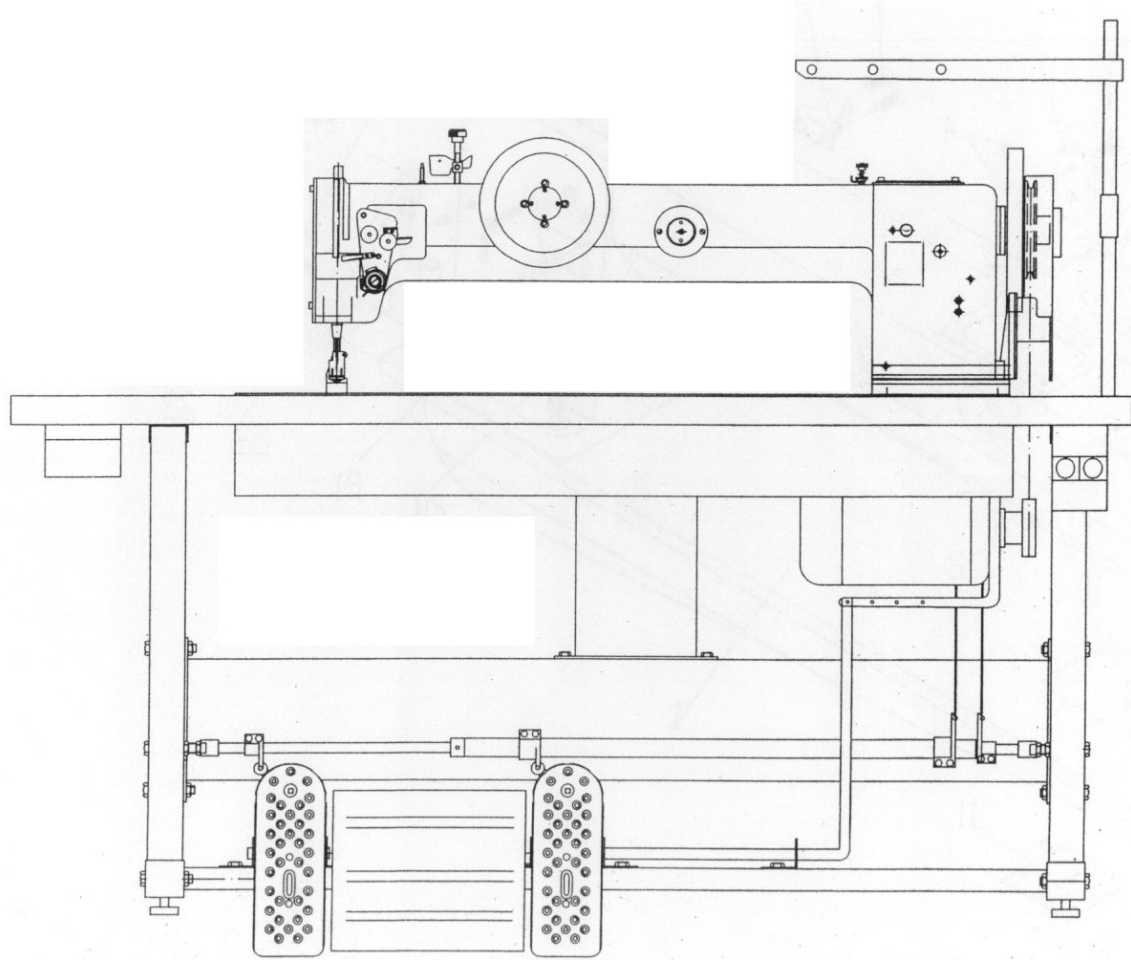

chassis components

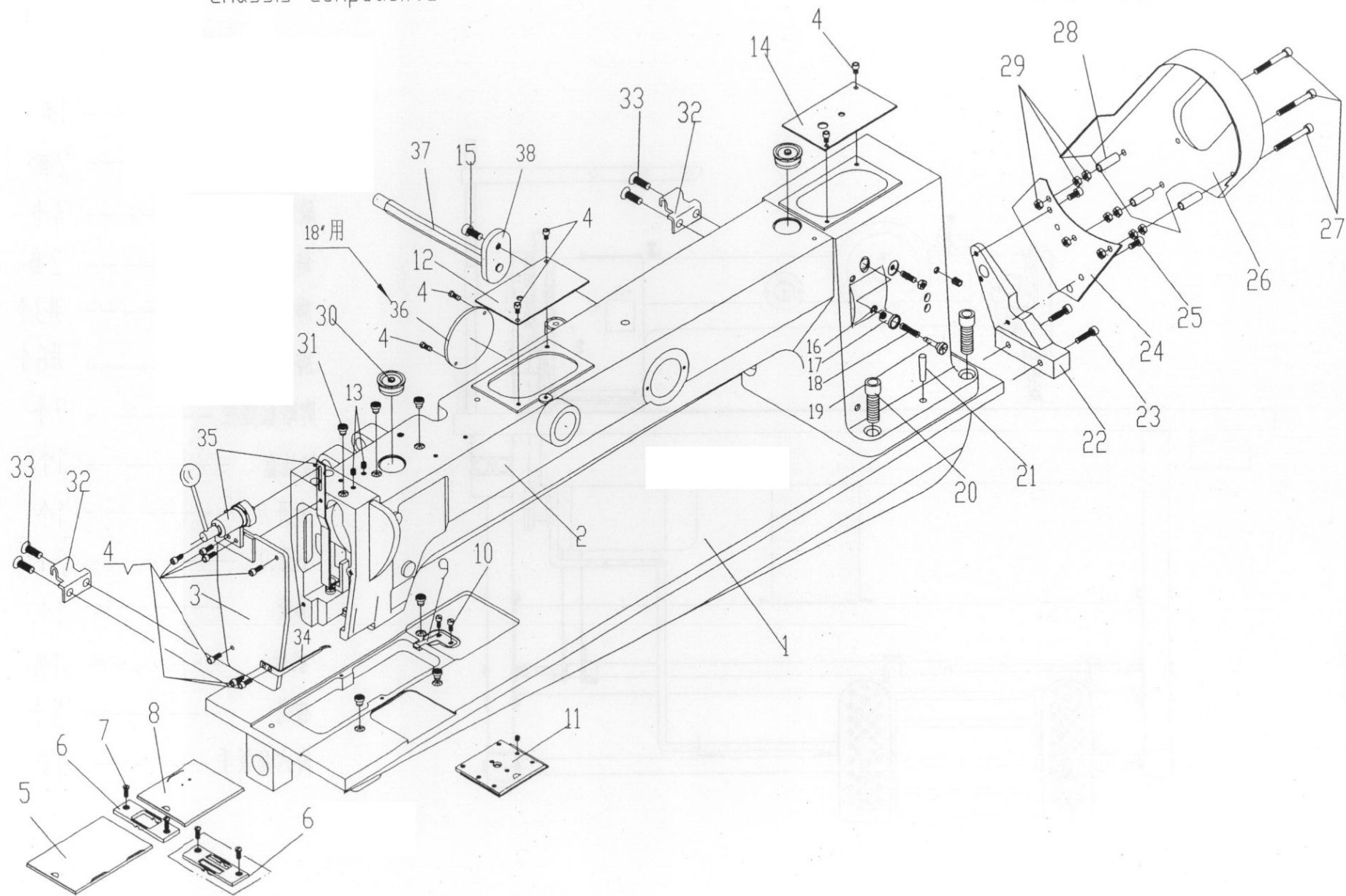

_ chassis components

		Description		
1	EL0101	bottom plate	1	
2	EL0102	head case	1	
3	EL0103	face plate	1	
4	GS13312	screw	13	M5x12
5	EL0105	push plate (outside)	1	
6	EL0106	needle plate	1	
6	EL0106A	needle plate	1	
7	EL0107	screw	2	
8	EL0108	push plate (inside)	1	
9	EL0109	push plate stop spring	1	
10	GS13212	screw	2	M4x12
11	EL0111	push plate (front)	1	
12	EL0112	upper cover plate	1	
13	GS11410	screw	2	M6x10
14	EL0114	upper cover plate (back)	1	
15	GS13520	screw	1	M8x20
16	E-04	E-shaped snap spring	1	φ4
17	EL0117	regulation thimble	1	
18	EL0118	spring	1	
19	EL0119	pin shaft	1	
20	GS13740	screw	4	M12x40
21	GS105	pin	2	φ8
22	M0110	angle stand	1	
23	GS13416	screw	2	
24	M0111	belt hood support	1	
25	GS13416	screw	2	
26	M0112	belt hood	1	
27	GS13460	screw	3	M6x60
28	G0100	belt hood screw saddle	3	
29	GL204	nut	9	M6
30	GK208	large oil scal	2	
31	GK209A	small oil scal	6	
32	GXR222	hinge2	2	
33	GS17520	screw	4	
34	EL0134	finger controller thread (lower)	1	
35	EL0135	hand uplifting presser assembly	1	204
36	EL0136 (18")	friction wheel window cover plate	1	
37	EL0137	support bar	1	
38	EL0138	support bar connecting plate	1	

upper shaft.thread take-up

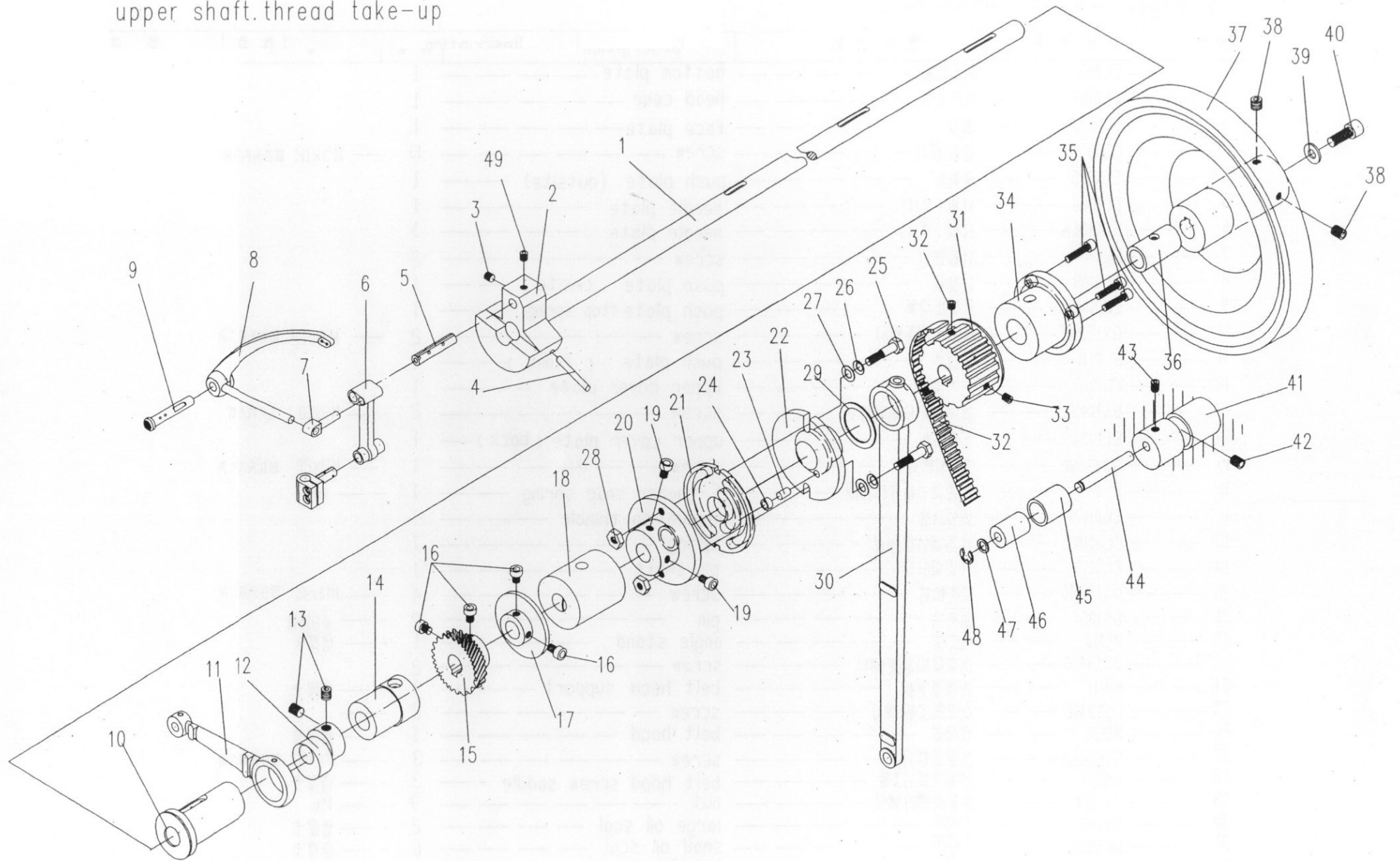

upper shaft.thread take-up

				Description					Description					
1	EL0201			upper shaft	1			26	DR-07			spring washer	2	∅7
2	EL0202			needle bar crank	1			27	D-07			washer	2	∅7
3	GSX11406			screw	1	M6x0.75x6		28	GL204			nut	2	15/64x28
4	GX107			pin	1	∅5x40		29	EL0229			washer	1	
5	EL0205			pin shaft	1			30	EL0230			feeding connecting rod	1	
6	EL0206			needle bar small connecting rod	1			31	EL0231			upper shaft synchronization belt pulley	1	
7	EL0207			swing shaft	1			32	EL0232			synchronization belt	1	
8	EL0208			thread take-up lever	1			33	GS11410			screw	2	M6x10
9	EL0209			pin shaft	1			34	EL0234			bushing (back)	1	
10	G0109			bushing (front)	1	204		35	GS13320			screw	3	M5x20
11	EL0211			lifting pressing foot connecting rod	1			36	G0124			back insite bushing	1	
12	EL0212			eccentric wheel	1			37	M0207			big pulley	1	
13	GSX11508			screw	2	M8x1x8		38	GS11512			screw	1	M8x12
14	EL0214			center bushing (front)	1			39	D-08			washer	1	
15	EL0215			driven large pinion	1			40	GSX13520			screw	1	M8x1x20
16	GS13410			screw	2	M6x10		41	EL0241			tensioner pulley seat	1	
17	GP112			driving friction wheel	1	204-762		42	GS11516			screw	1	M8x16
18	EL0218			center bushing (Back)	1			43	EL0243			screw	1	1/4x40
19	GS13414			screw	2	M6x14		44	EL0244			tensioner pulley shaft	1	
20	EL0220			feeding cam locating seat	1			45	EL0245			tensioner pulley	1	
21	EL0221			feeding cam locating dist	1			46	EL0246			tensioner pulley outside set	1	
22	EL0222			feeding cam	1			47	EL0247			washer	1	
23	EL0223			feeding cam locating shaft	1			48	E-07			E-shaped snap spring	1	∅7
24	EL0224			positioning thimble	1			49	GSX10404			screw	1	M6x0.75x4
25	EL0225			screw	2									

needle bar.pendulum presser foot upper feeding

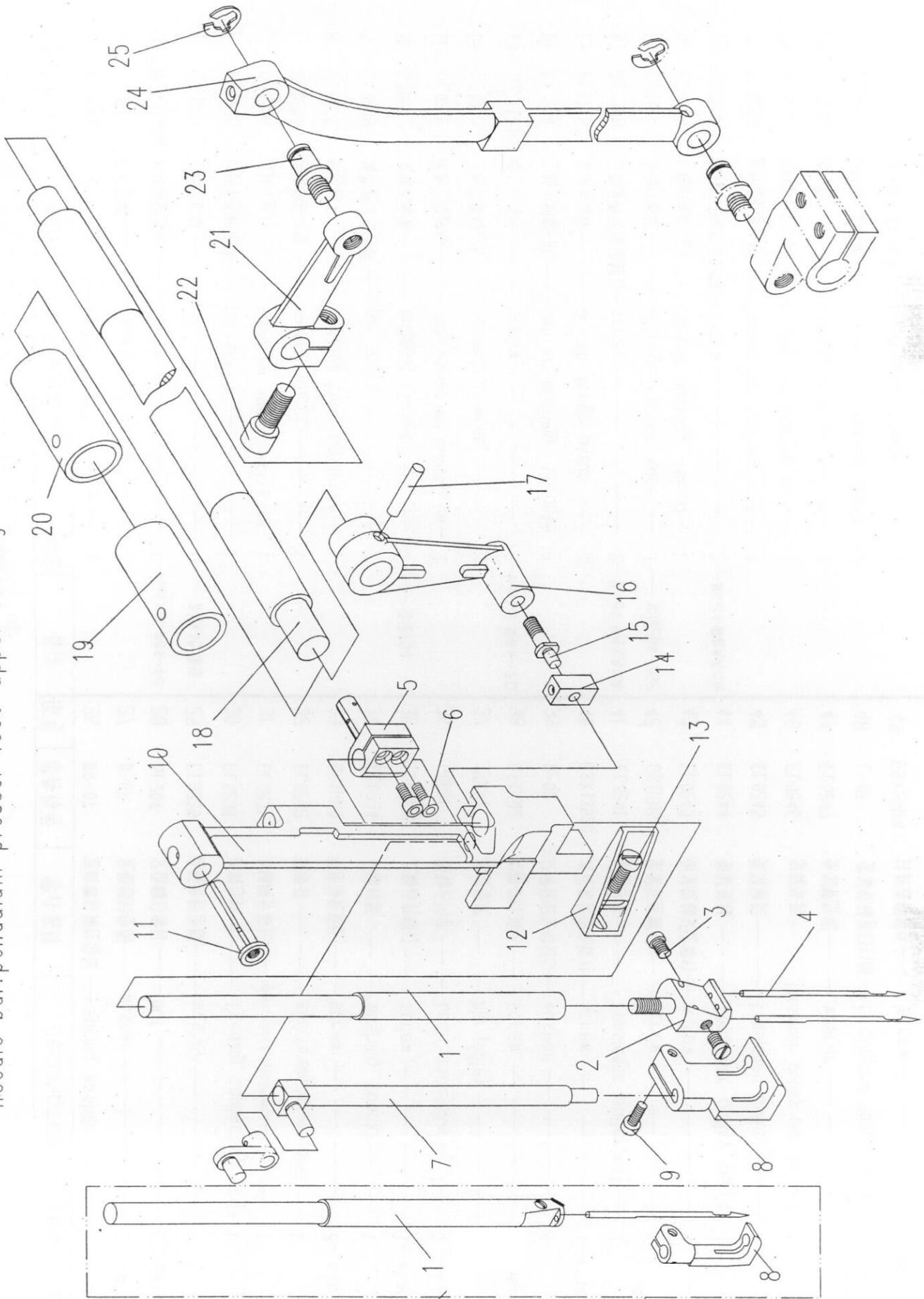

needle bar.pendulum presser foot.upper feeding

		Description		
1	EL0301	needle bar	1	
1	EL0301A	needle bar	1	
2	EL0302	needle clip	1	
3	EL0303	screw	2	3/16x32
4	DY23	needle	2	
5	EL0305	needle bar connecting shaft	1	
6	GS13208	screw	2	M4x8
7	EL0307	small presser bar	1	
8	EL0308	small presser foot	1	
8	EL0308A	small presser foot	1	
9	EL0309	screw	1	11/64x40
10	EL0310	pendulum stand	1	
11	EL0311	positioning shaft	1	
12	EL0312	needle bar oriented board	1	
13	GS12312	screw	1	M5x12
14	EL0314	block	1	
15	EL0315	pin	1	
16	EL0316	front crank of pendulum stand	1	
17	X-0522	pin	1	∅5x22
18	EL0318	upper feeding shaft	1	
19	EL0319	upper front bushing	1	
20	EL0320	upper bask bushing	1	
21	EL0321	pendulum stand bask crank	1	
22	GS13518	screw	1	M8x18
23	EL0323	pin	1	
24	EL0324	upper feeding big connecting rod	1	
25	E-08	E-shaped snap spring	1	(∅8)

presser.uplifting presser foot

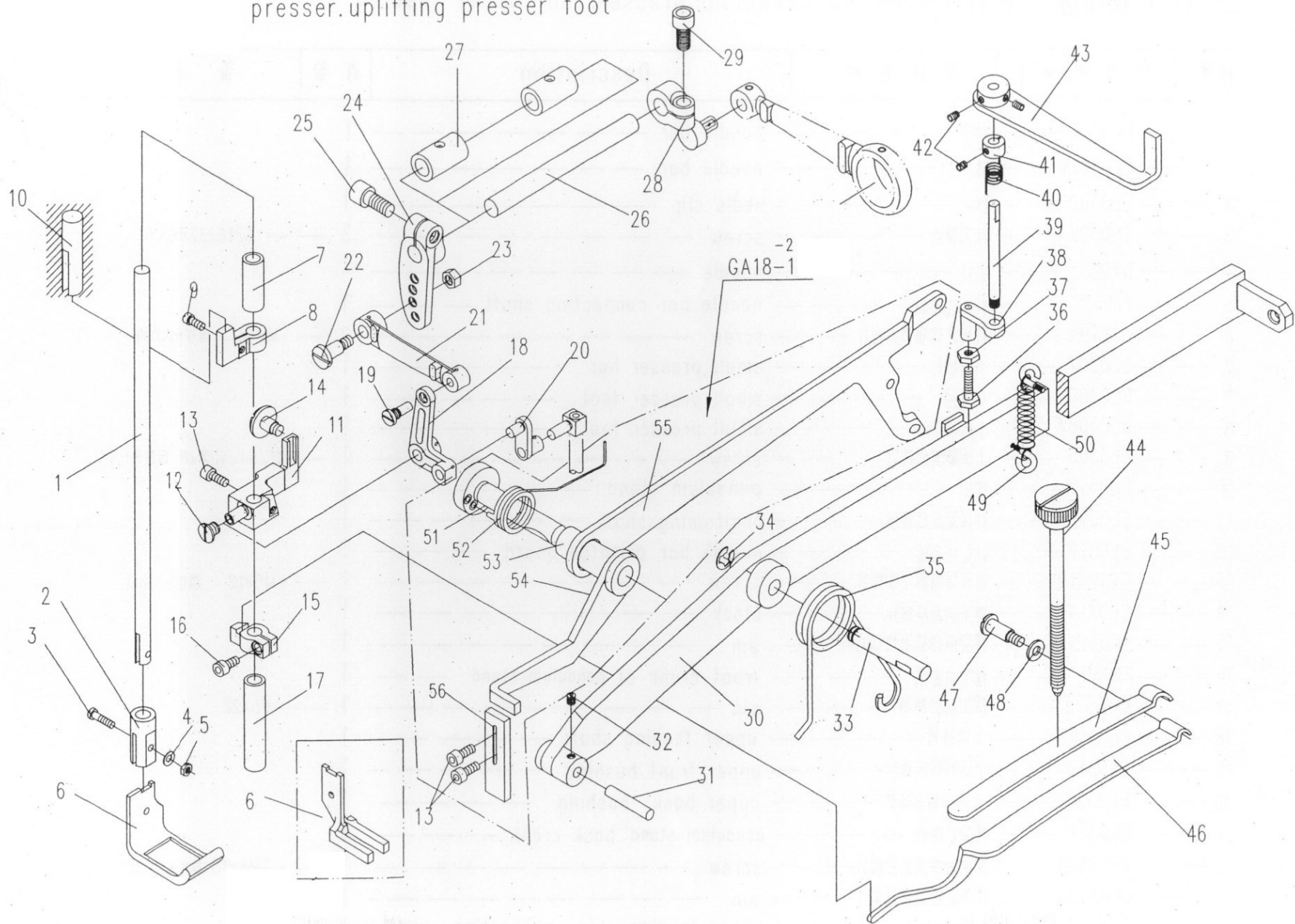

presser.uplifting presser foot

Description			Description				
1	EL0401	large presser bar	1	26	EL0426	small shaft	1
2	EL0402	Connecting sleeve	1	27	EL0427	small shaft bushing	1
3	GS13218	screw	1 M4x18	28	EL0428	bar crank (back)	1
4	GK212	washing	1 ϕ 4	29	GS13516	screw	1 M8x16
5	GL202	nut	1 M4	30	EL0430	uplifting presser lever	1
6	EL0406	large presser foot	1	31	EL0431	uplifting lever small shaft	1
6	EL0406A	large presser foot	1	32	GS11305	screw	1 M5x5
7	EL0407	upper bushing	1	33	EL0433	centre small shaft	1
8	EL0408	presser bar guide block	1	34	E-08	E-shaped snap spring	1 (ϕ 8)
9	EL0409	screw	1 11/64x40	35	EL0435	lever torsional spring	1
10	EL0410	presser bar guide bushing	1	36	GS14320	screw	1 M5x20
11	EL0411	lifting guide stand	1	37	GL203	nut	1 M5
12	EL0412	screw	1	38	EL0438	limit handle arm	1
13	GS13316	screw	1 M5x16	39	EL0439	limit handle small shaft	1
14	EL0414	screw	1	40	EL0440	limit handle torsional spring	1
15	EL0415	spring base	1	41	EL0441	retaining ring	1
16	GS13310	screw	1 M5x10	42	GS11204	screw	3 M4x4
17	EL0417	lower bushing	1	43	EL0443	location handle	1
18	EL0418	presser lifting rocker arm	1	44	EL0444	screw	1
19	EL0419	screw	1	45	EL0445	presser bar spring(auxiliary)	1
20	GU111	pendulum presser lifting small link	1 204	46	EL0446	presser bar spring	1
21	EL0421	front crank connecting rod	1	47	EL0447	screw	1
22	EL0422	pin	1	48	D-06	washer	1
23	EL0423	nut	1 1/4x40	49	EL0449	spring finger	2
24	EL0424	presser lifting front crank	1	50	EL0450	spring	1
25	GS13518	screw	1 M8x18	51	GZ141	uplifting presser lever shaft	1 18"
				52	GW212	torsin spring	1 18"
				53	GK264	uplifting presser lever shaft thimble	1 18"
				54	EL0454	uplifting presser lever (front)	1 18"
				55	GK222	uplifting presser lever (back)	1 18"
				56	EL0456	location plate	1 18"
				57	GS13312	screw	2 18"

M5x12

lower feeding shaft

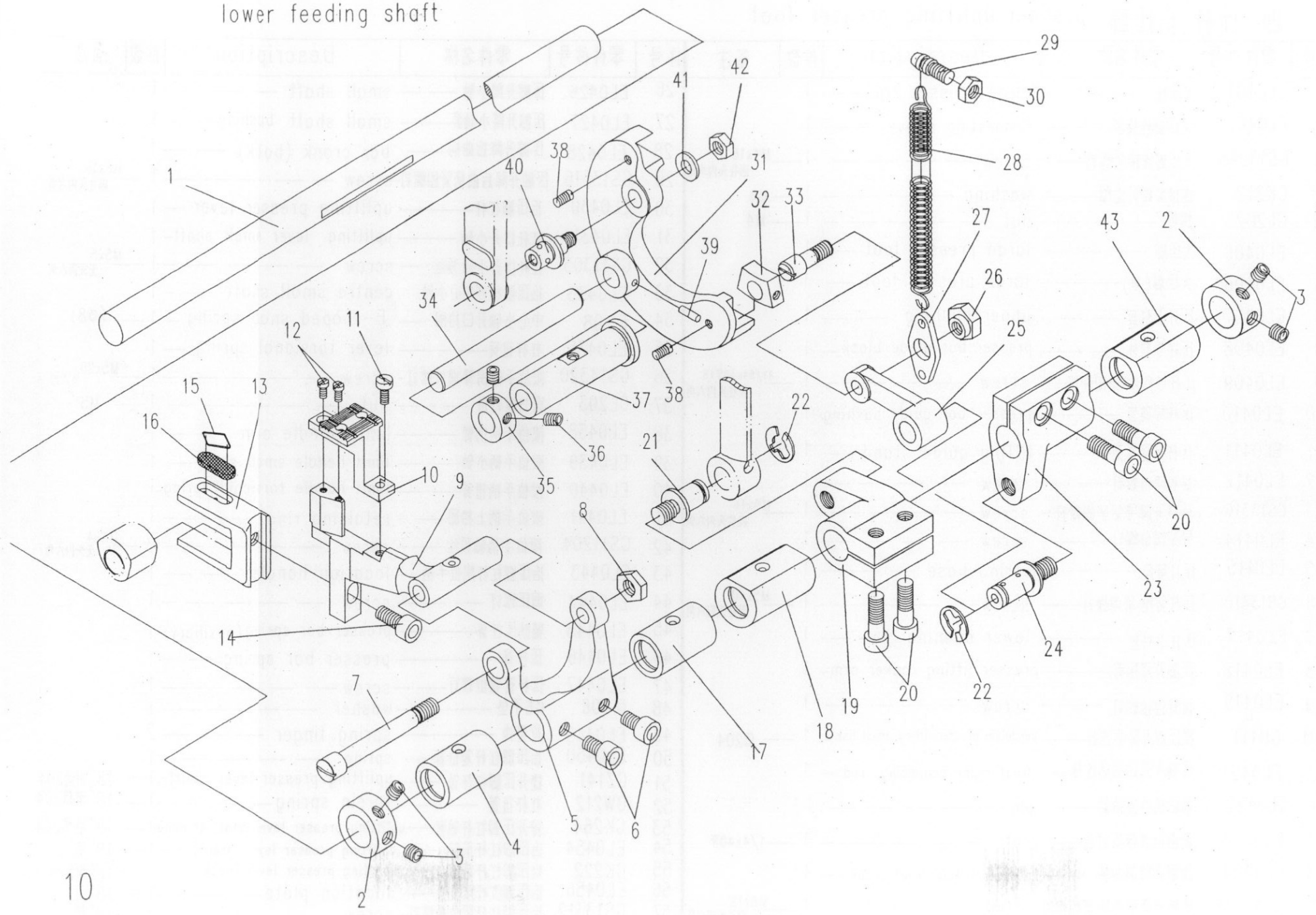

lower feeding shaft

Description				Description			
1	EL0501	feeding shaft	1	24	EL0524	pin	1
2	GK255	retaining ring	2 (204)	25	EL0525	reversing link	1
3	GS11406	screw	4 M6x6	26	EL0526	nut	1 15/64x28
4	EL0504	front bushing	1	27	EL0527	reversing spring plate	1
5	EL0505	feed dog shelf block	1	28	EL0528	reversing spring	1
6	GS13412	screw	1 M6x12	29	EL0529	reversing spring stud	1
7	EL0507	small shaft	1	30	GL204	nut	1 M6
8	EL0508	nut	1 9/32x28	31	EL0531	reversing limit seat	1
9	EL0509	feed dog shelf	1	32	EL0532	small block	1
10	EL0510	feed dog	1	33	EL0533	pin	1
11	EL0511	screw	1 9/64x40	34	EL0534	small shaft	1
12	EL0512	screw	2 1/8x40	35	GK220	retaining ring	1 (204)
13	EL0513	lifting dog feeth fork	1	36	GS11305	screw	2 M5x5
14	GS13416	screw	1 M6x16	37	EL0537	bushing	1
15	EL0515	snap spring	1	38	GS10206	screw	2 M4x6
16	EL0516	oil felt	1	39	X-320	pin	1 ϕ 3x20
17	EL0517	median bushing (left)	1	40	EL0540	cam pin	1
18	EL0518	median bushing (right)	1	41	D-06	washer	1
19	EL0519	upper feeding bar crank	1	42	GL204	nut	1 M6
20	GS13416	screw	4 M6x16	43	EL0543	back bushing	1
21	EL0521	pin	1				
22	E-08	E-shaped snap spring	2 (ϕ 8)				
23	EL0523	lower feeding bar crank	1				

lower shaft

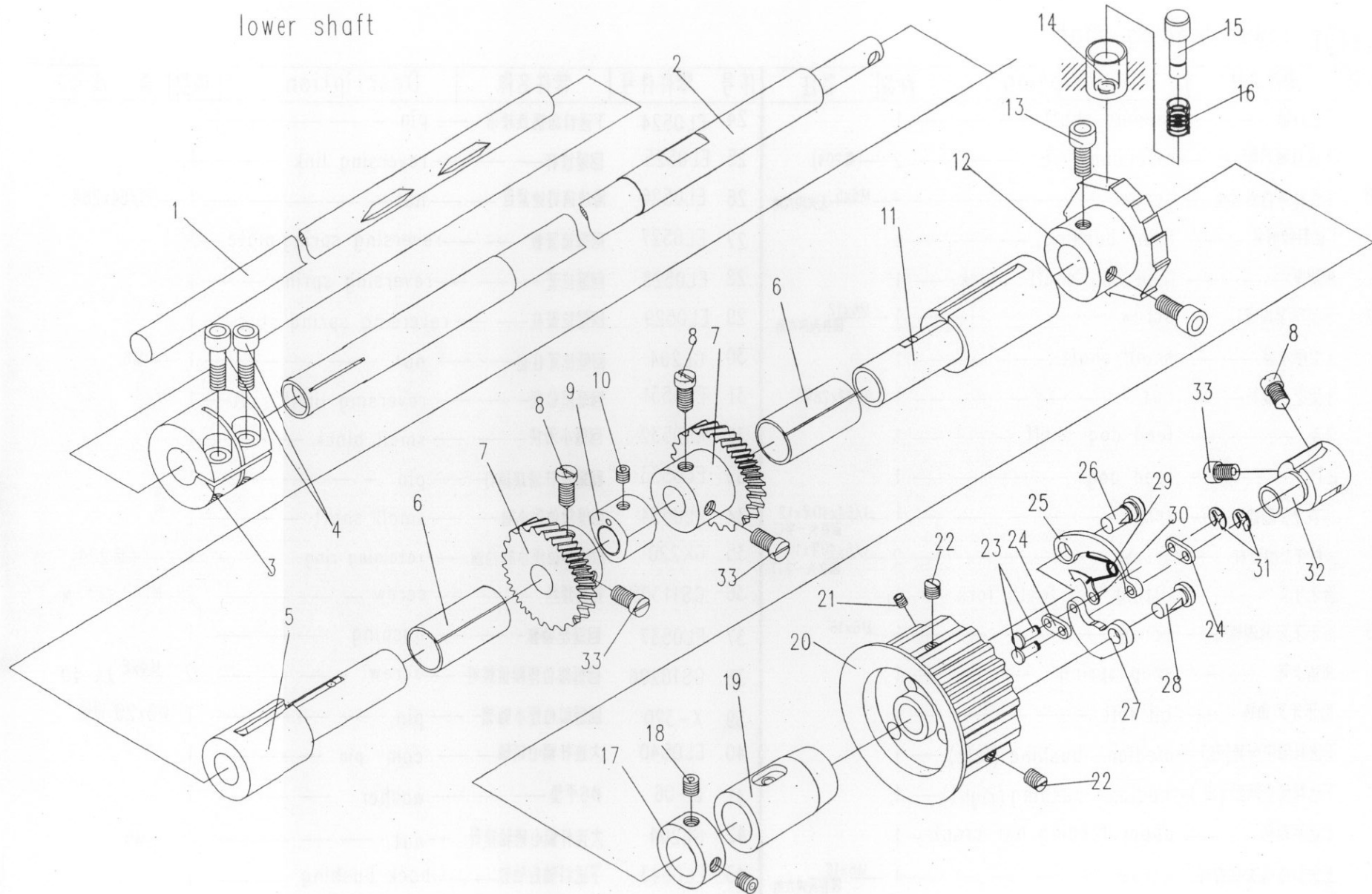

lower shaft

		Description		
1	EL0601	lower shaft I	1	
2	EL0602	lower shaft II	1	
3	EL0603	tight ring	1	
4	GS13416	screw	2	M6x16
5	EL0605	front shaft bushing	1	
6	EL0606	hook saddle cam bushing	2	
7	EL0607	driving mass gear	2	
8	EL0608	screw	2	M6x0.75
9	EL0609	lifting dog cam	1	
10	GS11305	screw	1	M5x5
11	EL0611	median bushing	1	
12	EL0612	reset ratchet	1	
13	GS11406	screw	1	M6x6
14	EL0614	ratchet stop bushing	1	
15	EL0615	stop pin	1	
16	EL0616	stop spring	1	
17	GK255	retaining ring	1	(204)
18	GS11406	screw	2	M6x6
19	EL0619	back shaft bushing	1	
20	EL0620	lower shaft connection belt pulley	1	
21	GS11204	screw	1	M4x4
22	EL0622	screw	2	3/16x32 3/16x32
23	EL0623	connecting pin	2	
24	EL0624	connecting plate	2	
25	EL0625	lock plate spring	1	
26	EL0626	pin	1	
27	EL0627	lock plate	1	
28	EL0628	pin	1	
29	EL0629	reset finger	1	
30	EL0630	reset finger spring	1	
31	E-03	E-shaped snap spring	2	(ϕ 3)
32	EL0632	insite bushing	1	
33	EL0633	screw	2	M6x0.75

hook saddle (left)

hook saddle (right)

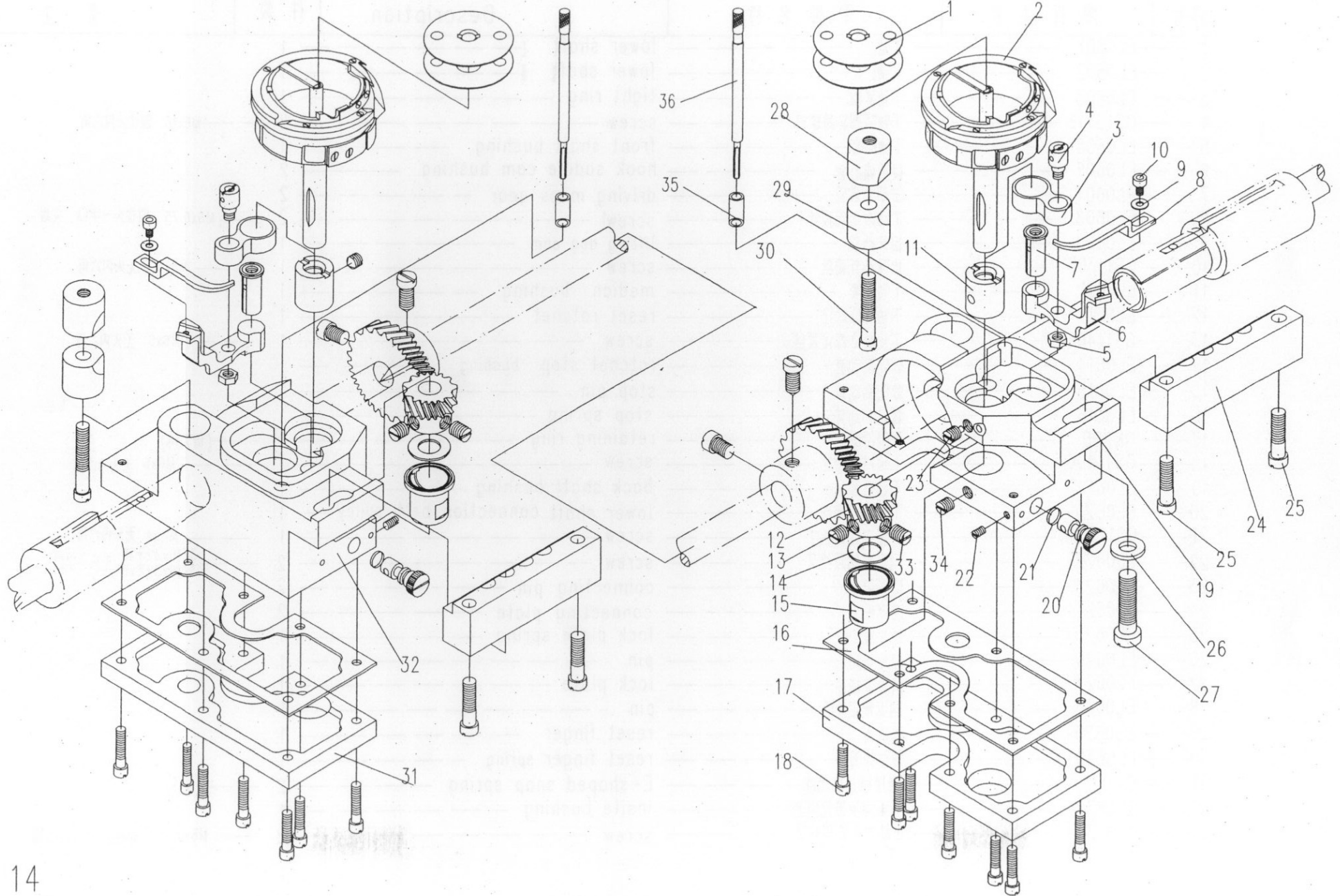

left,right hook saddle

		Description		
1	EL0701	bobbin	2	
2	EL0702	hook complete	2	
3	EL0703	bobbin case limit link	2	
4	EL0704	pin	2	
5	EL0705	nut	2	11/64x40
6	EL0706	bobbin case limit block	2	
7	EL0707	pin	2	
8	EL0708	bobbin case limit plate	2	
9	GK211	washer	2	(ϕ 3)
10	GS13108	screw	2	M3x8
11	EL0711	hook bushing (upper)	2	
12	EL0712	hook driven small gear	2	
13	EL0713	screw	2	M6x0.75
14	EL0714	washer	2	
15	EL0715	hook bushing (lower)	2	
16	EL0716	hook saddle gasket	2	
17	EL0717	oil reservoir (right)	1	
18	EL0718	screw	14	9/64x40
19	EL0719	hook saddle (right)	1	
20	EL0720	oil regulating rod	2	
21	EL0721	o-ring	2	
22	EL0722	screw	2	1/8x40
23	EL0723	screw	2	7/32x32
24	EL0724	hook saddle holder block	2	
25	EL0725	screw	4	7/32x32
26	D-06	washer	2	
27	EL0727	screw	2	9/32x28
28	EL0728	hook saddle positioning bushing (upper)	2	
29	EL0729	hook saddle positioning bushing (lower)	2	
30	EL0730	screw	4	7/32x32
31	EL0731	oil reservoir (left)	1	
32	EL0732	hook saddle (left)	1	
33	EL0733	screw	2	M6x0.75
34	EL0734	screw	2	7/32x32
35	EL0735	oil gauge guide	2	
36	EL0736	oil gauge	2	

thread tension, thread passing

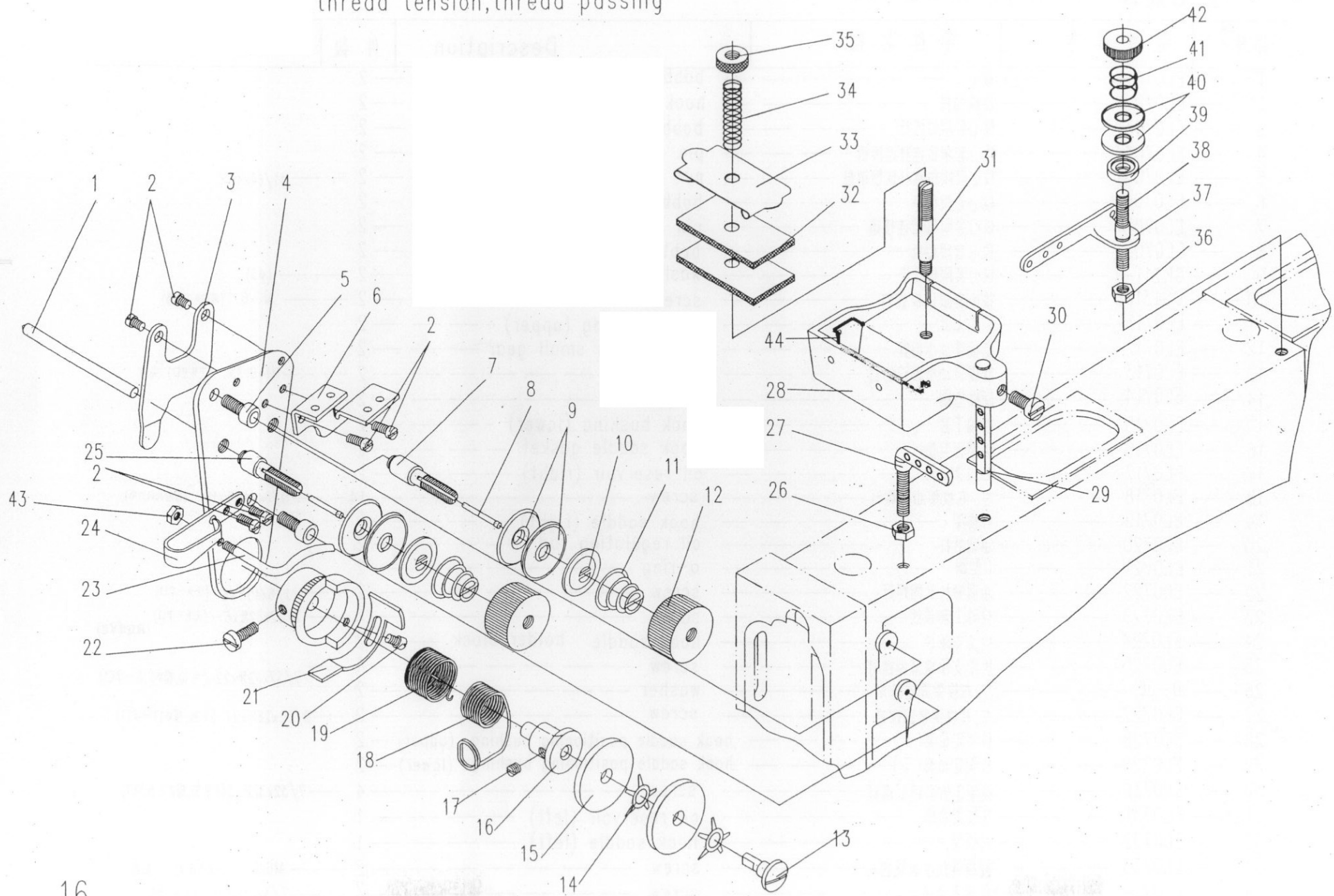

thread tension,thread passing

				Description					Description											
1	EL0801	-----	-----	thread releasing rod	-----	-----	-----	1	24	EL0824	-----	-----	-----	finger controller thread (middle)	-----	-----	-----	1		
2	EL0802	-----	-----	screw	-----	-----	-----	6	9/64x40	25	EL0825	-----	-----	-----	tension screw (short)	-----	-----	-----	1	
3	EL0803	-----	-----	thread releasing plate 1	-----	-----	-----	1	26	GL203	-----	-----	-----	passing bolt nut	-----	-----	-----	1	M5	
4	EL0804	-----	-----	location plate	-----	-----	-----	1	27	EL0827	-----	-----	-----	passing bolt	-----	-----	-----	1		
5	GS13312	-----	-----	screw	-----	-----	-----	2	M5x12	28	EL0828	-----	-----	-----	lubricating-oil cup	-----	-----	-----	1	
6	EL0806	-----	-----	thread drawing rack	-----	-----	-----	1	29	EL0829	-----	-----	-----	locating bar	-----	-----	-----	1		
7	EL0807	-----	-----	screw (long)	-----	-----	-----	1	30	GS13310	-----	-----	-----	screw	-----	-----	-----	1	M5x10	
8	EL0808	-----	-----	loosen bolt	-----	-----	-----	2	31	EL0831	-----	-----	-----	oil pad screw	-----	-----	-----	1		
9	GK231	-----	-----	tension plate	-----	-----	-----	4	(204)	32	EL0832	-----	-----	-----	oil pad	-----	-----	-----	2	
10	GK232	-----	-----	thread releasing plate	-----	-----	-----	2	(204)	33	EL0833	-----	-----	-----	presser oil pad plate	-----	-----	-----	1	
11	GW115	-----	-----	thread tension spring	-----	-----	-----	2	(204)	34	EL0834	-----	-----	-----	spring	-----	-----	-----	1	
12	GL204	-----	-----	tension nut	-----	-----	-----	2	(204)	35	GL103	-----	-----	-----	nut	-----	-----	-----	1	(204)
13	EL0813	-----	-----	thread passing wheel bolt	-----	-----	-----	1		36	GL203	-----	-----	-----	nut	-----	-----	-----	1	M5
14	EL0814	-----	-----	pentagon spring tablet	-----	-----	-----	2		37	EL0837	-----	-----	-----	tension thread stand	-----	-----	-----	1	
15	EL0815	-----	-----	thread passing wheel	-----	-----	-----	2		38	EL0838	-----	-----	-----	tension thread stud	-----	-----	-----	1	
16	EL0816	-----	-----	thread passing seat	-----	-----	-----	1		39	EL0839	-----	-----	-----	nylon washer	-----	-----	-----	1	
17	EL0817	-----	-----	screw	-----	-----	-----	1	11/64x40	40	EL0840	-----	-----	-----	tension thread plate	-----	-----	-----	2	
18	EL0818	-----	-----	thread take-up spring	-----	-----	-----	1		41	EL0841	-----	-----	-----	spring	-----	-----	-----	1	
19	EL0819	-----	-----	thread take-up torsion spring	-----	-----	-----	1		42	EL0842	-----	-----	-----	nut	-----	-----	-----	1	
20	EL0820	-----	-----	screw	-----	-----	-----	1	9/64x40	43	EL0843	-----	-----	-----	nut	-----	-----	-----	1	9/64x40
21	EL0821	-----	-----	limit spring stop	-----	-----	-----	1		44	EL0844	-----	-----	-----	oil cup presser thread spring	-----	-----	-----	1	
22	EL0822	-----	-----	screw	-----	-----	-----	1	11/64x40											
23	EL0823	-----	-----	controller thread bolt	-----	-----	-----	1												

hand wheel, built-in thread coiling guard

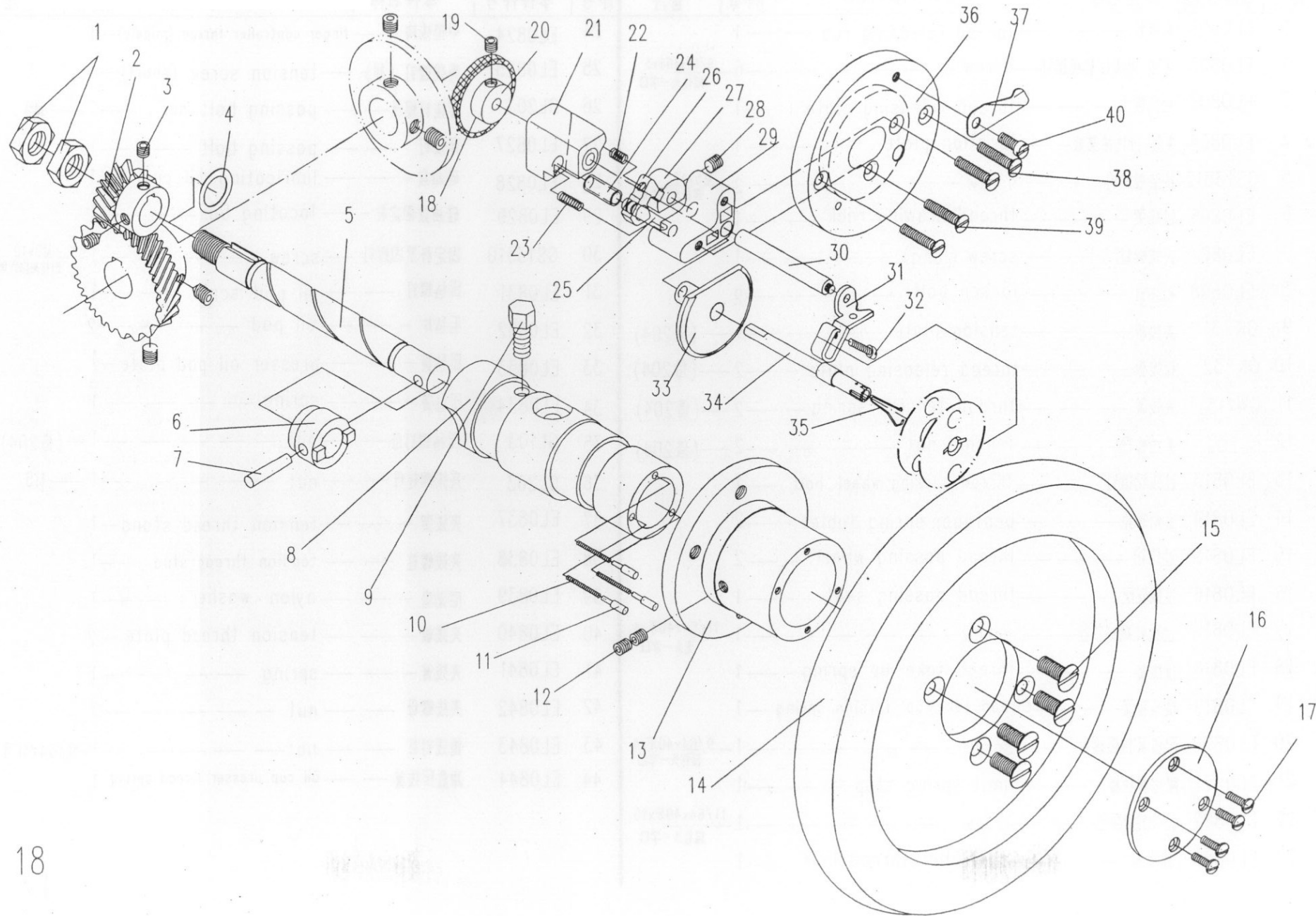

hand wheel,built-in thread coiling guard

		Description					Description		
1	GL206	lock nut	2	M10x1	24	EL0924	presser plate shaft	1	
2	EL0902	driving small gear	1		25	EL0925	presser plate small bushing	1	
3	GS11305	screw	2	M5x5	26	EL0926	thread coiling presser plate	1	
4	EL0904	washer	1		27	EL0927	thread coiling controller plate	1	
5	EL0905	hand pulley shaft	1		28	GS11305	screw	1	M5x5
6	EL0906	hand pulley disengaging bushing	1		29	EL0929	thread coiling controller plate seat	1	
7	X-522	pin	1	∅5x22	30	EL0930	full reel springboard shaft	1	
8	EL0908	hand pulley bushing	1		31	EL0931	full reel springboard	1	
9	EL0909	screw	1	17/64x28	32	GS13112	regulate screw	1	M3x12
10	EL0910	hand pulley disengaging spring	3		33	EL0933	presser plate base dial	1	
11	EL0911	pin	3		34	EL0934	bobbin shaft	1	
12	GS11305	screw	2	M5x5	35	EL0935	bobbin shaft spring	1	
13	EL0913	centring bushing	1		36	EL0936	bobbin winder connecting dial	1	
14	EL0914	hand pulley	1		37	EL0937	small scissors	1	
15	GS17414	screw	4	M6x14	38	GS17218	screw	2	M4x18
16	EL0916	hand pulley disengaging tablet	1		39	GS17212	screw	2	M4x12
17	GS17110	screw	4	M3x10	40	GS13208	screw	1	M4x8
18	EL0918	rubber ring	1						
19	GS11306	screw	1	M5x6					
20	EL0920	driven friction wheel	1						
21	EL0921	thread coiling presser plate seat	1						
22	EL0922	presser spring 2	1						
23	EL0923	presser spring 1	1						

stand components

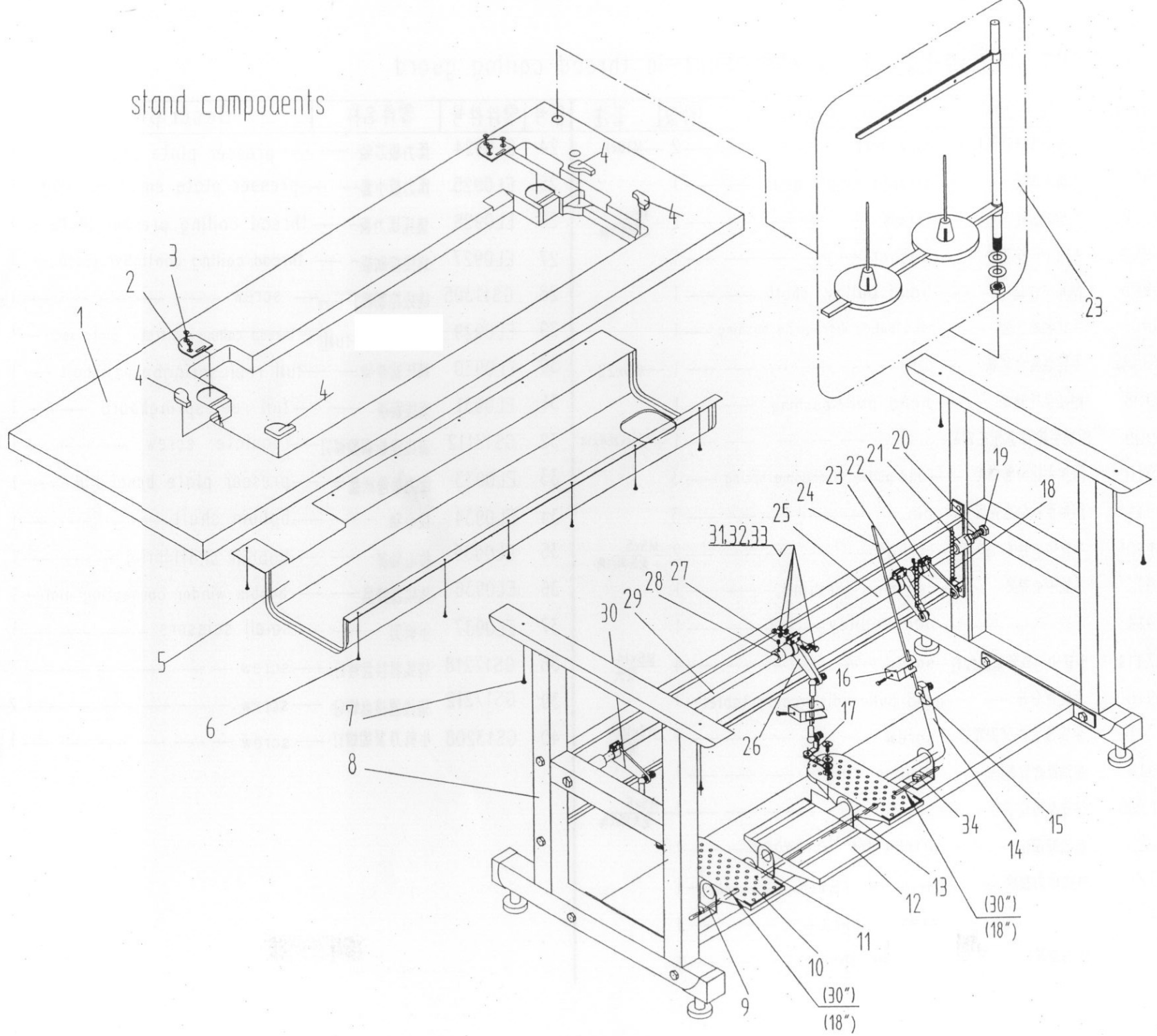

		Description		
1	EL1001	table	1	
2	GKR200	hinge	2	(204)
3	GBS115	screw	5	(204)
4	EL1004	rubber cushion	4	
5	EL1005(30")	oil pan	1	
5	EL1005(18")	oil pan	1	
6	GBS112	screw	12	(204)
7	GBS114	screw	4	(204)
8	EL1008	stand	1	
9	GKR184	foot step axle seat	2	(204)
10	GKR111	small pedal	2	(204)
11	EL1011	foot step axle seat B	2	(204)
12	EL1012	large pedal	1	M6x6
13	EL1013	large pedal axle seat	1	
14	EL1014	clutch shaft	1	
15	GXC222	electromaznetic lower rod clutch motor	3	(204)
16	GKR183	rod adjusting device	3	(204)
17	EL1017	small pedal connecting rod	1	M6x6
18	GKR209	zipper	1	(204)
19	GKR112	put	4	M12
20	GKR118	support screw	2	M12x100
21	GKR183	adjusting thimble	2	
22	EL1022	smal hole driven connecting red	1	30",18"
23	EL1023	large hole driven connecting red	1	30",18"
24	GXC118	electromaznetic upper rod clutch motor	3	
25	EL1025	6" tube	1	30",18"
26	EL1026	large hole driving connecting red	1	
27	GS11406	screw	2	
28	EL1028	retaining ring	2	
29	EL1029	4" tube	1	30",18"
30	EL1030	smal hole driving connecting red	1	
31	GL204	put	8	M6
32	D-06	washer	8	Ø6
33	GS13425	screw	8	M6x25
34	M1014	thread stand	1	
35	GS14515	screw	7	M8x15